

ACTUAL SIZE

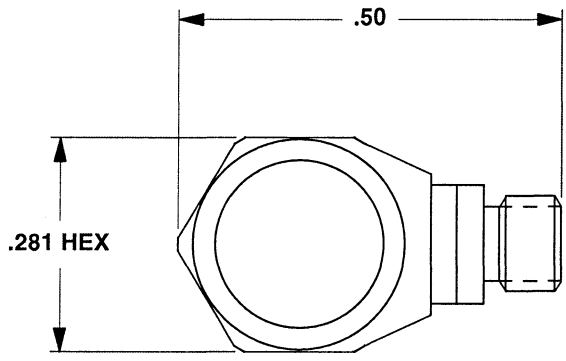

ARROW INDICATES SENSE AND DIRECTION OF ACCELERATION FOR POSITIVE GOING OUTPUT SIGNAL

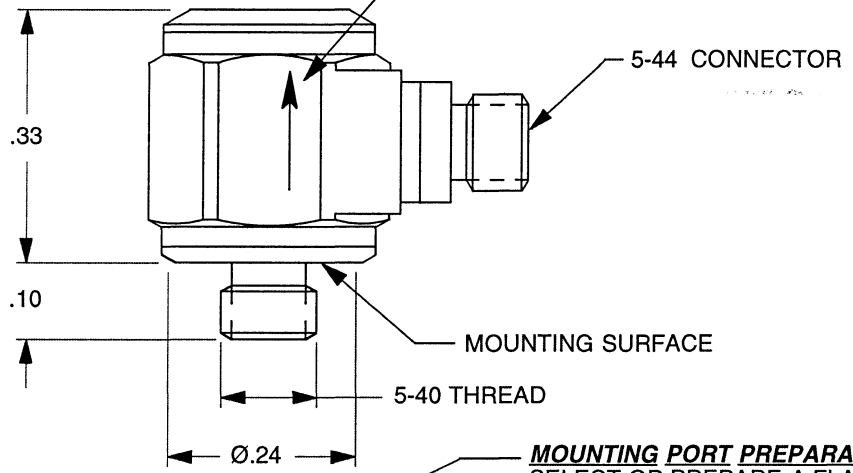

**MOUNTING PORT PREPARATION: 3035B1**  
SELECT OR PREPARE A FLAT AREA OF AT LEAST Ø.250, FLAT TO .001 TIR.  
AT THE CENTER, DRILL #38 (Ø.101) X .150 DEEP, MIN.  
TAP 5-40 UNC-2B X .125 DEEP, MIN.

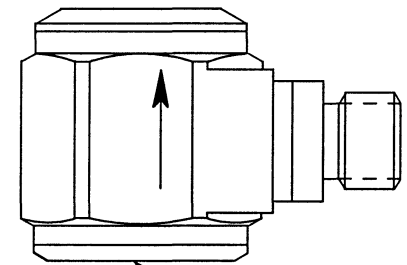
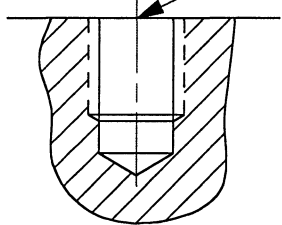

MOUNTING SURFACE

**MOUNTING SURFACE PREPARATION: 3035B1G**  
SELECT OR PREPARE A FLAT AREA OF AT LEAST Ø.250, FLAT TO .001 TIR. CLEAN TO REMOVE CONTAMINANTS. APPLY ADHESIVE TO SURFACE OR TO ACCELEROMETER AND PRESS TOGETHER UNTIL ADHESIVE SETS.



**MASTER ONLY IF IN RED** CHATSWORTH, CA.

SCALE	4X	REV	A	DATE	6/10/04	ECN	-
DATE	3/5/04		PART NO.	MODELS 3035B1, 3035B1G			
DRAWN	R.A.	CHECKED	N.C.	MAT'L			
APPROVED	<i>[Signature]</i>		6-10-04	NEXT ASSEMBLY		USED ON	

- 2. MOUNTING TORQUE ON .281 HEX: 3 TO 4 LB.-IN.
- 1. WEIGHT: 2.5 GRAMS.

**OUTLINE/INSTALLATION DRAWING, MODELS 3035B1, & 3035B1G LIVM ACCELEROMETERS**

DWG NO. **127-3035B1/G**  
SHEET 1 OF 1

**SPECIFICATIONS, MODELS 3035BX & 3035BXG  
LIVM ACCELEROMETERS**

**SPECIFICATIONS BY MODEL**

MODEL	RANGE F.S. (g)	MAXIMUM SHOCK (g)	SENSITIVITY (±10%) [1] (mV/g)	ELECTRICAL NOISE (g) (kHz)	NATURAL FREQUENCY (kHz)
3035B & BG	± 50	600/3000	100.0	0.0009	>45
3035B1 & B1G	± 500	600/3000	10.0	0.005	>45
3035B2 & B2G	± 100	600/3000	50.0	0.0015	>45
3035B3 & B3G	± 1000	600/3000	5.0	0.009	>45

**COMMON SPECIFICATIONS**

SPECIFICATION	VALUE	UNITS
<b>PHYSICAL</b>		
WEIGHT	2.5	grams
SIZE, HEX x HEIGHT	.281 (9/32) x .33	inches
MOUNTING PROVISION, 3035B	5-40 integral stud	
MOUNTING PROVISION, 3035BG	flat surface for adhesive mount	
CONNECTOR, RADIALLY MOUNTED	5-44 coaxial	
MATERIAL, HOUSING AND CONNECTOR	300 Series Stainless Steel	
<b>PERFORMANCE</b>		
FREQUENCY RANGE, ± 10%	0.5 to 10k	Hz
RESONANT FREQUENCY	>45	kHz
EQUIVALENT ELECTRICAL NOISE FLOOR	.007	g rms
LINEARITY [2]	± 1%	% F.S.
TRANSVERSE SENSITIVITY, MAX.	5	%
STRAIN SENSITIVITY	.002	g/με @ 250με
<b>ENVIRONMENTAL</b>		
MAXIMUM VIBRATION/SHOCK	600/3000	± g pk
TEMPERATURE RANGE, 3035B/BG, 3035B2/B2G	-60 to +225	°F
3035B1/B1G, 3035B3/B3G	-60 to +250	°F
SEAL, HERMETIC	Glass-to-metal and TIG welded	
COEFFICIENT OF THERMAL SENSITIVITY	.04	%/°F
<b>ELECTRICAL</b>		
SUPPLY CURRENT [3]	2 to 20	mA
SUPPLY COMPLIANCE VOLTAGE RANGE	+18 to +30	Volts
OUTPUT IMPEDANCE, TYP.	100	Ω
BIAS VOLTAGE	+11 to +13	Vdc
DISCHARGE TIME CONSTANT	1.0 to 2.0	seconds
OUTPUT SIGNAL POLARITY FOR ACCELERATION TOWARD TOP	Positive	
CASE GROUNDING	Case is grounded to electrical power ground	

[1] Measured at 100 Hz, 1g rms per ISA RP 37.2.

[2] Measured using zero-based best straight-line method, % of full scale (F.S.) or any lesser range.

[3] Do not apply power to this device without current limiting, 20 mA MAX. To do so will destroy the integral IC amplifier